

©GB

Water Trap QLAZ-26 and QLAZ-27
Instructions for Installation, Operation and maintenance

Installation

Coils equipped with drip tray have a drain pipe for connection to a water trap.

The QLAZ-26 is designed for max. 950 Pa sub-atmospheric pressure.

The QLAZ-27 is designed for max. 400 Pa pressure above atmospheric.

Fitting

Fit the water trap without tools as shown in the figure above and in the following order:

A. Connect the elbow with the drain pipe.

B. Connect the discharge pipe (32mm o.d.) to the water trap outlet.

The discharge pipe should be as short as possible and should be run with a continuous slope to a floor drain without any reduction in cross section. A clear space of at least 300 mm is needed below the unit for the water trap.

1. Drain pipe of the unit section.
2. Elbow.
3. Base frame, support leg or foundation with a height of at least 300 mm.
4. U-pipe.
5. Check valve with cleaning cover (not applicable to QLAZ-27).
6. 32 mm i.d. outlet with compression coupling.
7. Floor drain.

Important!

The water trap and discharge pipe must not be subjected to temperatures below 0 °C. If the unit is installed outdoors, the drain pipe, water trap and discharge pipe should be insulated. The water trap should not be exposed to direct sunlight.

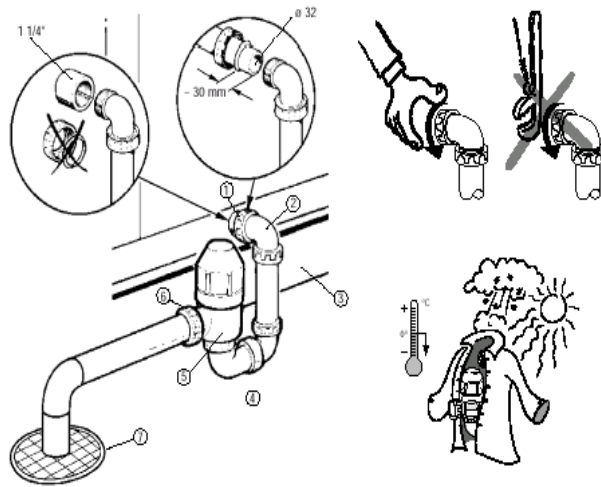

COILTECH

Coiltech AB: SE-614 81 Söderköping
 Phone +46 121-19100
 Fax +46 121-10101
 www.coiltech.com

Coiltech, Afrikalaan 303, BE-9000 Gent, Belgium
 Phone +32 9 218 71 30
 Fax +32 9 218 71 39



Head Office:
 33050 POCENIA (UD) | Via Giulio Locatelli, 22
 Phone +39 0432.772.001
 Fax +39 0432.779.594
 www.ecogroup.com
 info@ecogroup.com